

ASSEMBLY INSTRUCTIONS

! CASING MUST BE INSTALLED PRIOR TO EXTERIOR FINISH APPLICATION TO ALLOW FOR PROPER CASING FIT !

IMPORTANT: READ THE INSTRUCTIONS AND FAMILIARIZE YOURSELF WITH THE CASING PARTS AND PIECES BEFORE BEGINNING ASSEMBLY AND INSTALLATION.

Completed Brickmould 600 Window Frame

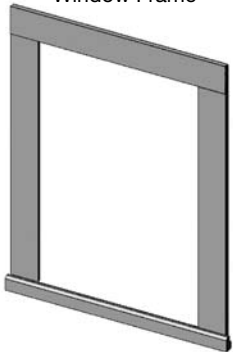

PACKAGE MATERIALS		
Item #	Qty.	Description
1	1	Head
2	2	Jamb
3	1	Bull Nose
4	2	Head End Cap
5	1	Bull Nose Cap - LH
6	1	Bull Nose Cap - RH
7	2	#8 x 2.5" Pan Head Screw
8	2	#8 x 1" Pan Head Screw
9	4	#8 x 0.625" Pan Head Screw

Drawn to Scale

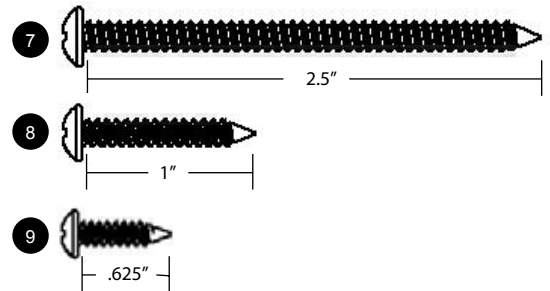

! DO NOT APPLY CASING UNTIL WINDOW HAS BEEN PROPERLY SEALED FROM WATER !

1. Check to see that all components in the table are included.
2. Layout all lineals on a flat surface and fit the first head and jamb joint together as seen in Fig. B.
3. Insert head end cap into joint.
4. Use (1) #8 x 1" and (1) #8 x 2.5" screws to assemble the joint (Do not over torque these screws. This will cause gapping of the joint)
5. Repeat for the opposite head/jamb joint.
6. Fit the first jamb and bull nose joint as seen in Fig. C.
7. Use (2) #8 x 0.625" screws to assemble the joint (Do not over torque these screws. This will cause gapping of the joint)
8. Repeat for other bull nose joint.

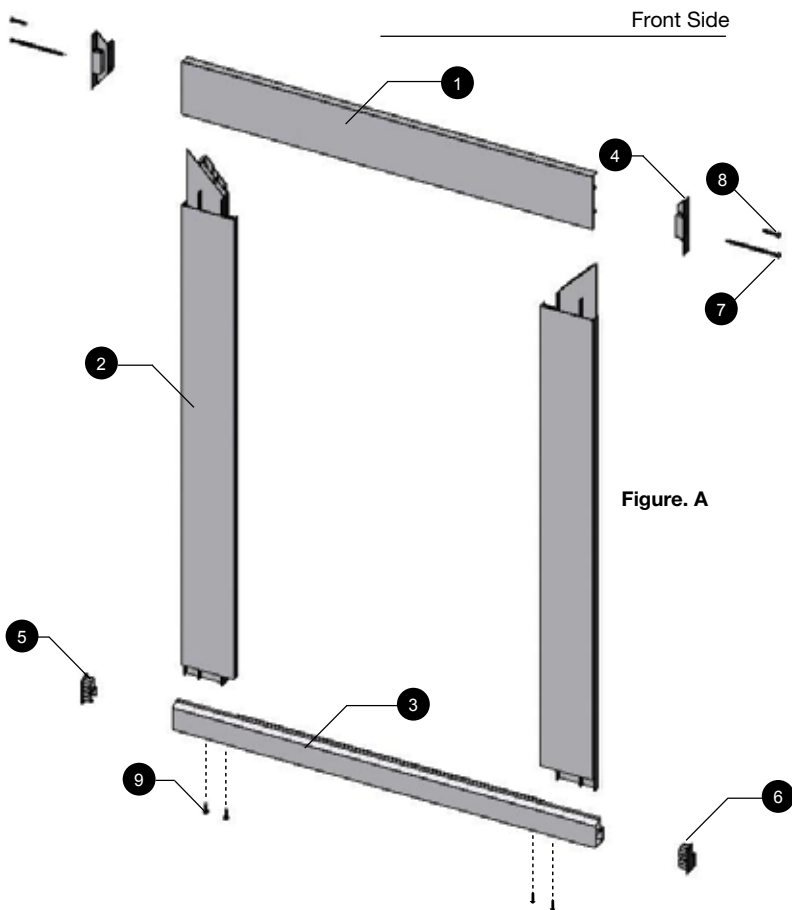

Figure. A

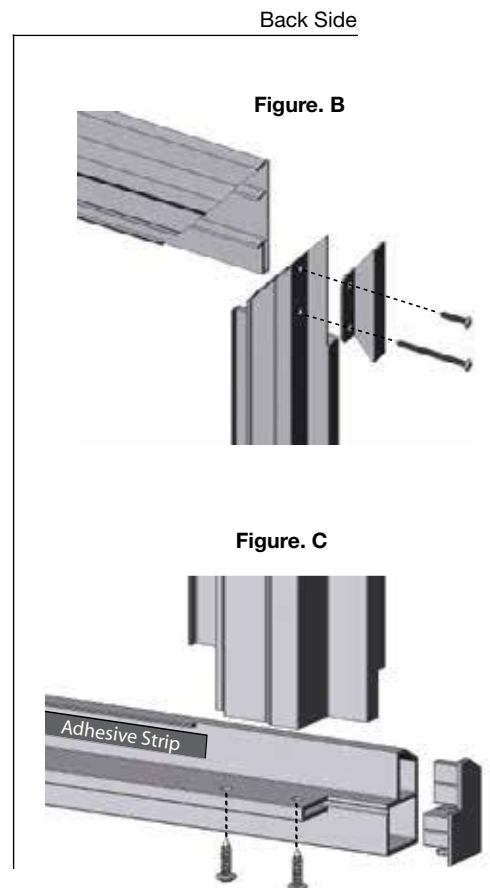

Figure. B

Figure. C